

RoHS

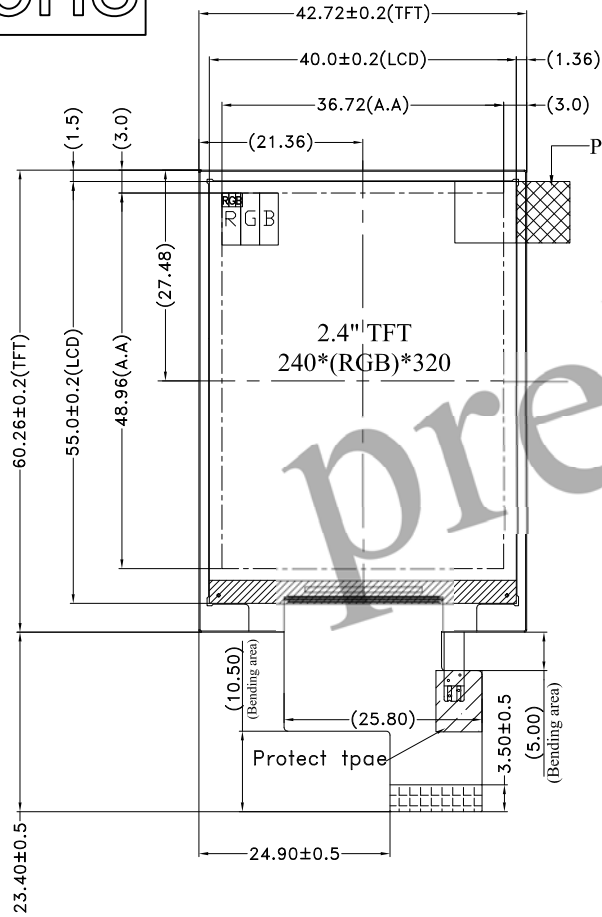

Singel 3 | B-2550 Kontich | Belgium | Tel. +32 (0)3 458 30 33  
 info@alcom.be | www.alcom.be  
 Rivium 1e straat 52 | 2909 LE Capelle aan den IJssel | The Netherlands  
 Tel. +31 (0)10 288 25 00 | info@alcom.nl | www.alcom.nl

ISSUE	MODIFY DESCRIPTION	DATE
T01	First Issue	2023.12.19



FPC展开出货  
FPC expand shipment

FPC ASSIGNMENT:

Pin	Signal	Pin	Signal
1	LED-	21	DB16
2	LED+	22	DB17
3	VDD	23	DOTCLK
4	GND	24	ENABLE
5	DB0	25	HSYNC
6	DB1	26	VSYNC
7	DB2	27	TE
8	DB3	28	CSX
9	DB4	29	SDA
10	DB5	30	SDO
11	DB6	31	DCX
12	DB7	32	WRX
13	DB8	33	RESET
14	DB9	34	IM1+IM2
15	DB10	35	IM3
16	DB11	36	RDX
17	DB12	37	NC
18	DB13	38	NC
19	DB14	39	NC
20	DB15		

MCU interface mode select.

Name	I/O	Description	Connect Pin		
IM3,IM2,IM1 IM0=0	1	The MCU interface mode select.			
		IM3	IM2+IM1	MPU Interface Mode	Data Pin
		0	0	80-8bit parallel I/F	DB[7:0]
		0	1	4-line 8bit serial I/F	SDA:in/out
1	0	80-16bit parallel I/F II	DB[17:10], DB[8:1]		
1	1	4-line 8bit serial I/F II	SDA:in SDO:out		

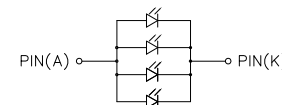

电路图CIRCUIT DIAGRAM  
(LED SMD 1\*4 = 4 dies)

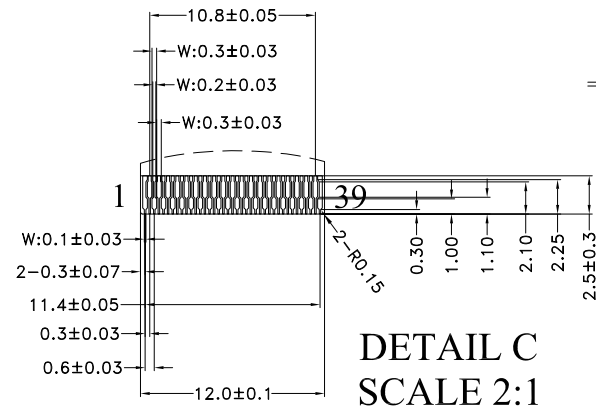

DETAIL C  
SCALE 2:1

Display Type	2.4" a-Si TFT, Normally White / Transflective
Display Resolution	240*(RGB)*320
Viewing Direction	10:00
Max. Ratio and Bias Level	
LCD Controller/Driver	ST7789T3-G
Logic Voltage	3.0V±0.3V
Operation Temperature	-20°C TO 70°C
Storage Temperature	-30°C TO 80°C
Backlight Speciality	LED Side (White), 4PCS, Vf=3.0V(typ.); If=60mA(Constant)
Reliability Test	Normal
Remark	

TITLE: Module Speciality			
PROJECT NO: EA TFT024-23ATNN			
▲:Special characteristic +:Safety characteristic Tolerance unless: x.x±0.3	▽:Critical dimension (...):Reference dimension Otherwise specified: x.xx±0.2		
THIRD ANGLE PROJECTION			
NAME	SIGN	DATE	
DRAWN	Luo shao lin		
CHECKED	Yang yong yu		
CHECKED	Lan Li juan		
APPROVED	Yu Hao		
REV: T01	UNIT: mm	SCALE: 1/1	SHEET: 1 OF 1

